

Appendix H: Current Conditions, Phase 4 Improvements, & Current Project Investments

High Street Bridge

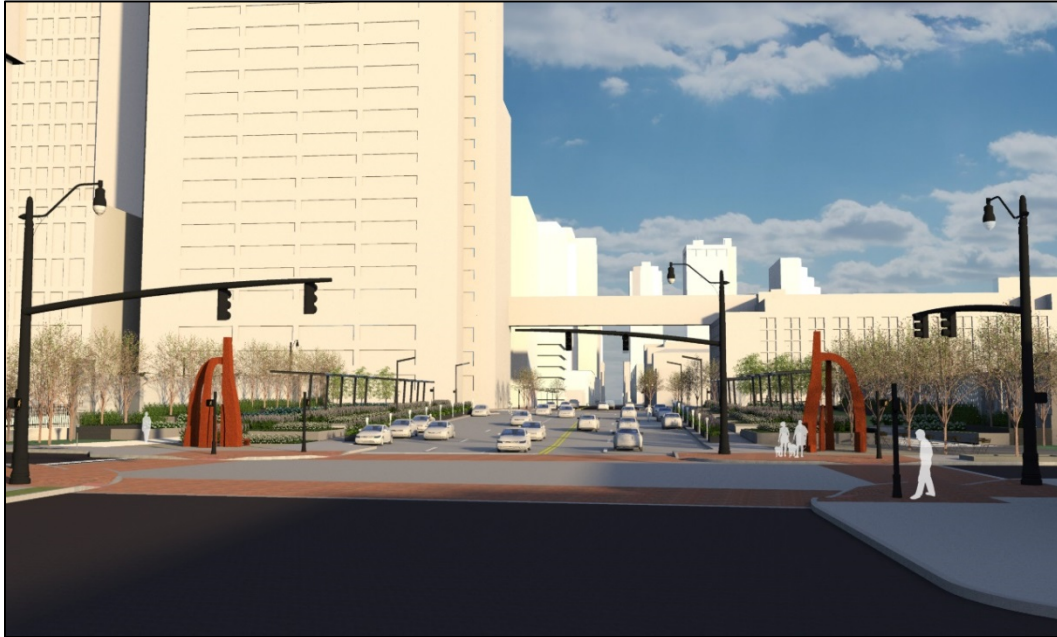

High St looking N over Livingston: proposed (above), existing (below)

High Street Bridge (continued)



High St on eastern sidewalk of bridge: proposed (above), existing (below)

High Street Bridge (continued)



High St on western sidewalk of bridge: proposed (above), existing (below)

Third Street Bridge



3rd St looking south: proposed (above), existing (below)

Fourth Street Bridge



4th St looking northwest: proposed (above), existing (below)

70 E. Front Street Ramp (Exit 100A) AM Congestion



Livingston Avenue, 4th Street, and Fulton Street - PM congestion due to vehicles attempting to enter freeway



Livingston Avenue PM congestion



I-70/I-71 westbound PM congestion





HIGH STREET

BEFORE



EXISTING VIEW TOWARD DOWNTOWN

SECTION

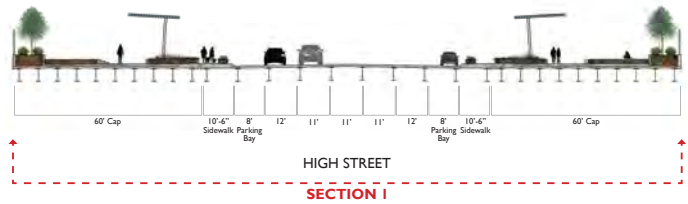

AFTER



VIEW 1



VIEW 2



VIEW 3

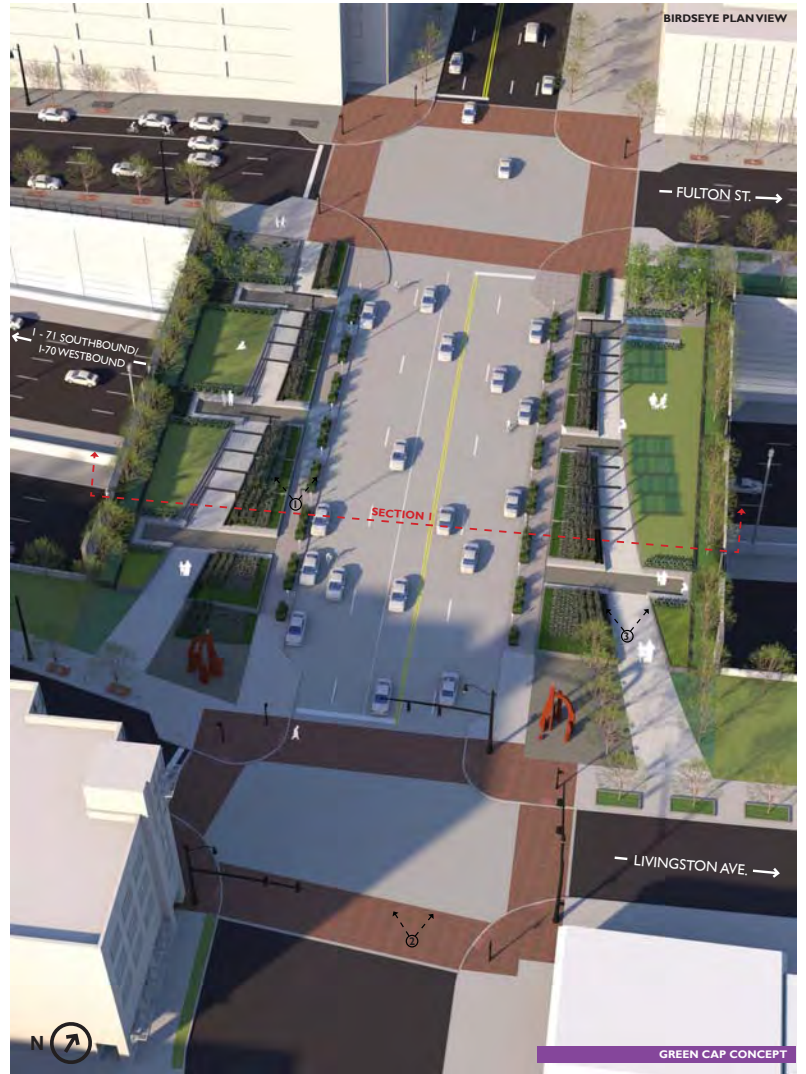



THIRD STREET

BEFORE



EXISTING VIEW TOWARD GERMAN VILLAGE

SECTION



THIRD STREET

SECTION I

AFTER

BIRDSEYE PLAN VIEW



BIRDSEYE PLAN VIEW



VIEW I





FOURTH STREET

BEFORE



EXISTING VIEW TOWARD DOWNTOWN

SECTION

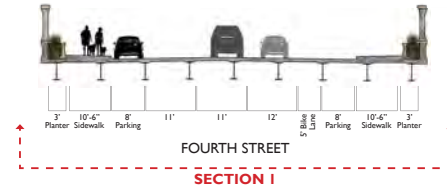

AFTER



Appendix H: Current Conditions, Phase 4 Improvements, & Current Project Investments

Long Street Bridge & Cultural Wall



Vertical Retaining Wall (near Nationwide Children's) showing the use of retaining walls to preserve or create new space for the surrounding neighborhoods:



Grant Street Bridge (top picture shows the start of construction with vertical retaining walls, and the second picture shows the bridge nearing completion and the newly filled in land:

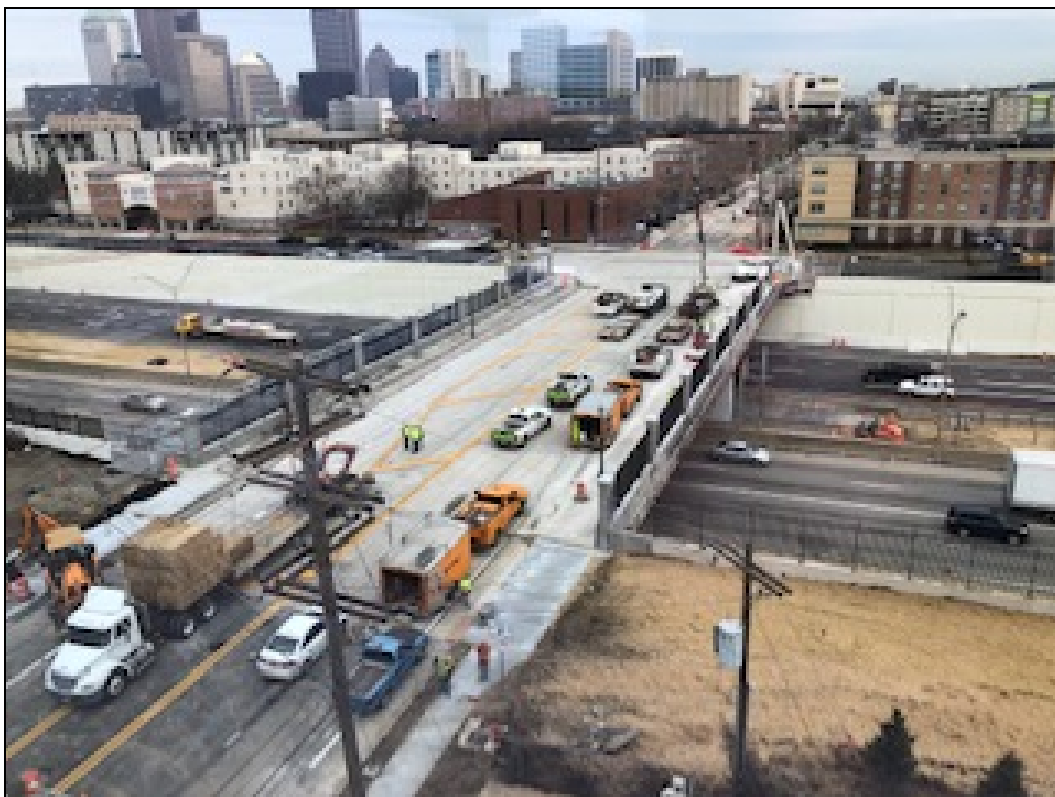

Vertical Retaining Wall Approaching Fourth Street Bridge, the wall provides more room for capacity while also providing new space for improvements on Fulton Street. Top photo shows construction underway, bottom photo shows the completed portion of retaining wall which will be extended during Phase 4:

